

Rag Bag Wool Handbag

featuring LANACOT WOOL TEXTURES
Handbag by Miriam Rawson



Materials:

- ½ yard Lanacot Textures, Color R041109 Cream, or your choice
- ½ yard lining (flannel)

Instructions:

NOTE: See accompanying illustrations, pages 3-8

1. Pre-wash the wool to 'felt' it. Place in washing machine with a towel and cold water. Dry in the dryer until damp/dry and smooth it out to finish drying.
2. Pin the pattern to the wool and use tailor tacks (or other methods) to mark the four corners of the handle opening as well as the end of the cutting line. See Illustrations 2, 2a, 2b, and 2c. for instructions.
3. Once the tailor tacks are in place, cut out two handbag pieces plus flower pieces as designated. Cut four handle pieces, 1" x 6¾".
4. Cut two lining and four pocket pieces (see pattern) from the flannel or other lining. Mark the handle opening as you did for the handbag.
5. Press the handle opening toward the wrong side of the lining. It should form a rectangular opening.
6. Pin two pocket pieces together, right sides together and stitch ¼" around four sides, leaving a 3" opening. Turn right side out and press. Repeat for second pocket.
7. Pin one pocket to each of the lining pieces. The bottom (has the 3" opening) of the pocket will be about 2" above the bottom edge of the handbag lining. The top should be about an inch below the handle opening.
8. Stitch each pocket to the lining, around the sides and bottom edge. Using the pattern as reference, stitch the pocket so it has three small pockets. Set the lining aside.
9. Press the handle flaps in half. You will note they are about ½" longer than the rectangular handle opening.
10. Pin one handle flap to the top edge of the handle opening on the right side of the handbag. Stitch through all layers, from one corner tailor tack to the other.
11. Repeat Steps 12 and 13 for the bottom edge of the opening.
12. Fold the flaps inside so the ends are on the wrong side of the bag. Stitch the sides in place so the triangle shape is folded to the back side. Repeat for the other side.
13. Place the lining pieces right sides together and stitch down each side to the dot indicated on the pattern leaving the bottom partially unstitched.
14. To embellish the front of the handbag, line up the 'Large Flower' piece on the handbag. Note the X on the pattern for placement. Stitch the flower in place using your machine. If it is too thick, you may need to hand stitch, folding the petals up as you stitch.
15. Stitch the second circle of petals, and a third in the same manner.
16. Fold one of the center petals in half. The folded edge will be on the bottom and you will roll the center piece as noted in the illustration. Stitch the bottom edge so it won't come loose when you are trying to stitch it to the center of the rose.
17. Fold the petals, one by one, and gather them slightly along the rounded edges. Stitch them around the center, one by one, curving the gathered edge slightly as you stitch in place. Continue stitching the petals in place until you have covered the center area. Note the photograph. Note: You may have to cut out a few more petals.
18. If you want the outer flower petals to stand up more, you can make a tiny running stitch around the outer edges of the petals and pull the thread slightly to 'gather.'
19. Once the flower is finished, place the handbag pieces right sides together and stitch a generous ¼" from the raw edges.
20. Place the lining inside the handbag, right sides together, matching the seams on the sides. Pin in place and machine stitch around the entire top edge of the handbag.
21. To turn right side out, pull the purse through the bottom opening of the lining.
22. Hand stitch the lining closed and push down into the handbag so the handle openings line up. Press the top edge.
23. Hand stitch the lining to the handbag handle opening.
24. Topstitch around the top edge, about ½" from the edges. *Your handbag is ready for an elegant evening.*

Illustrations ~ 1.

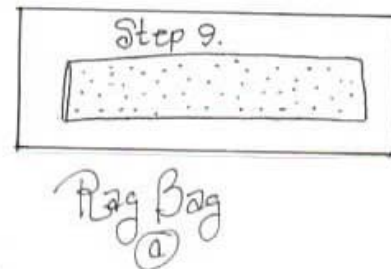
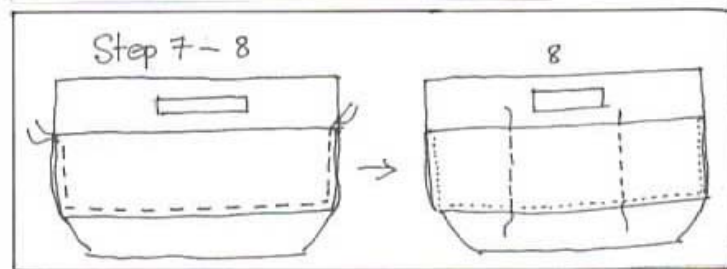
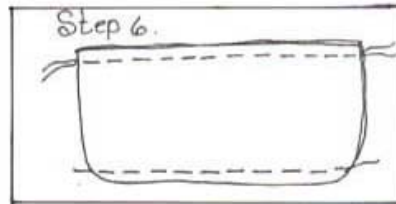
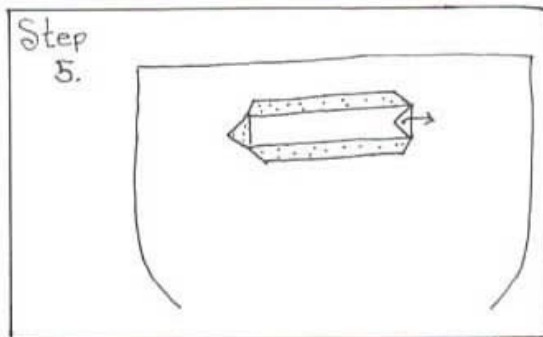
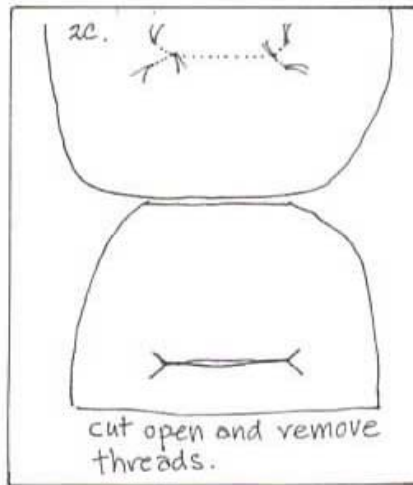
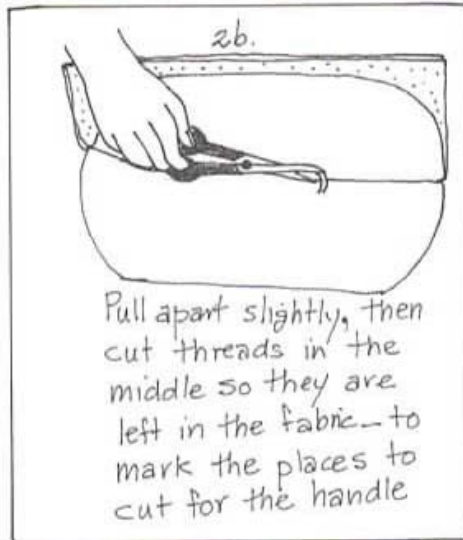
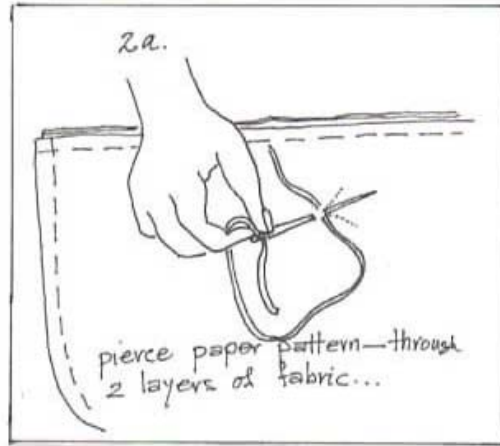

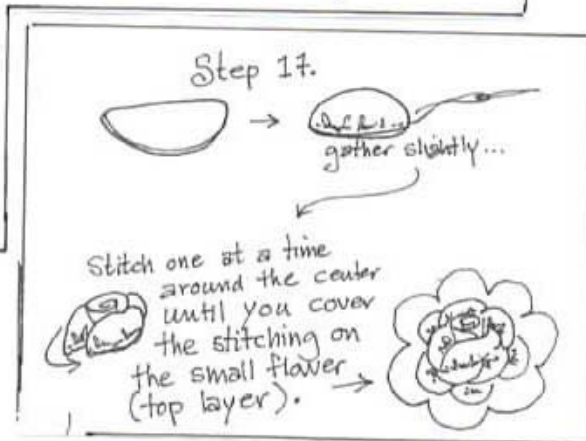
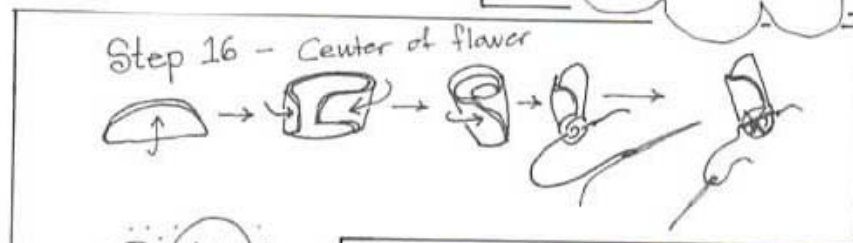
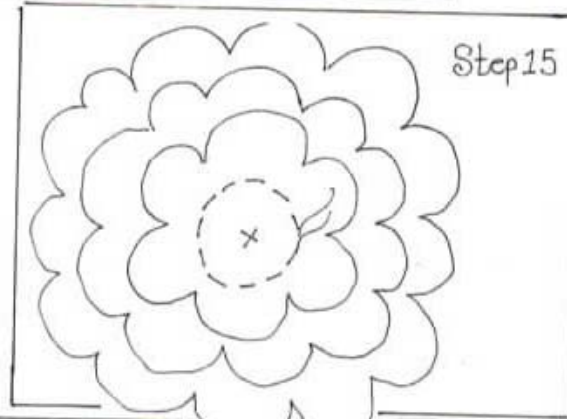
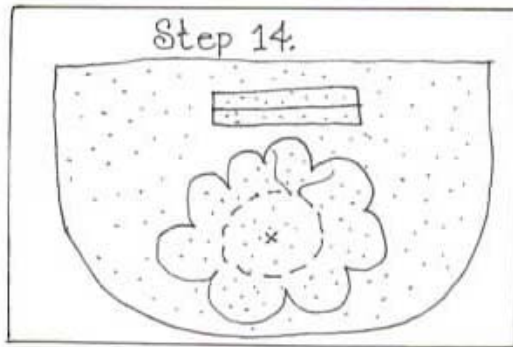
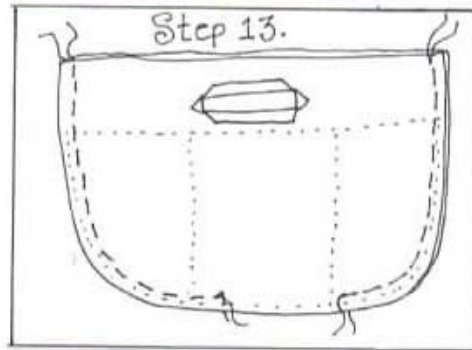
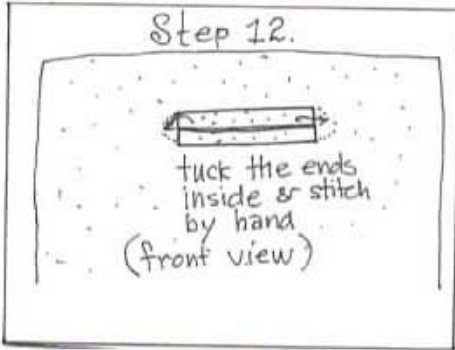
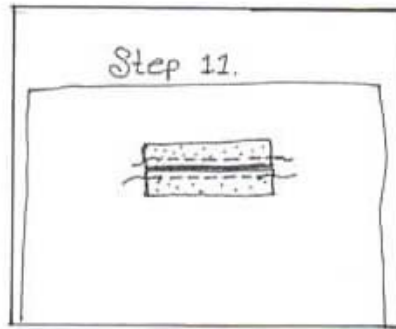
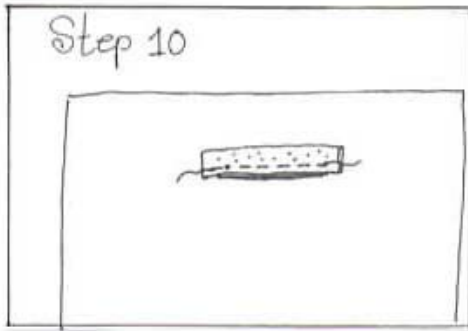

Illustrations - 3

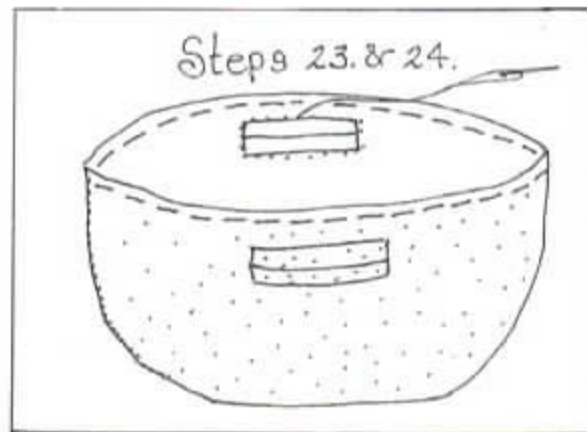
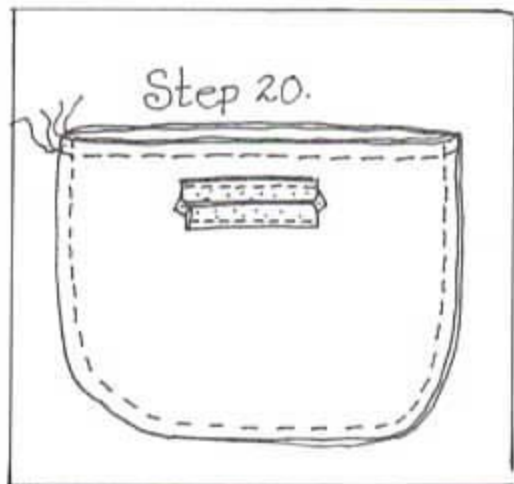
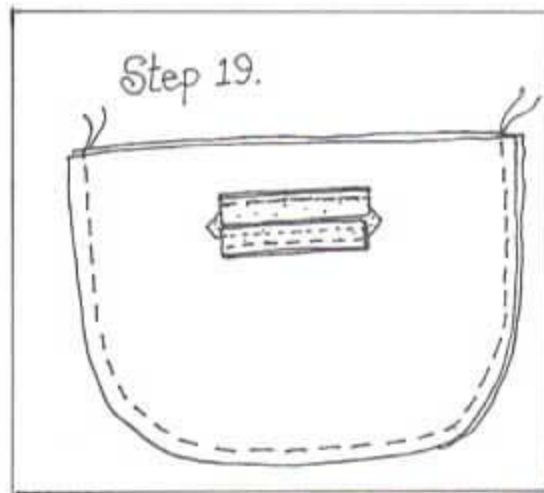

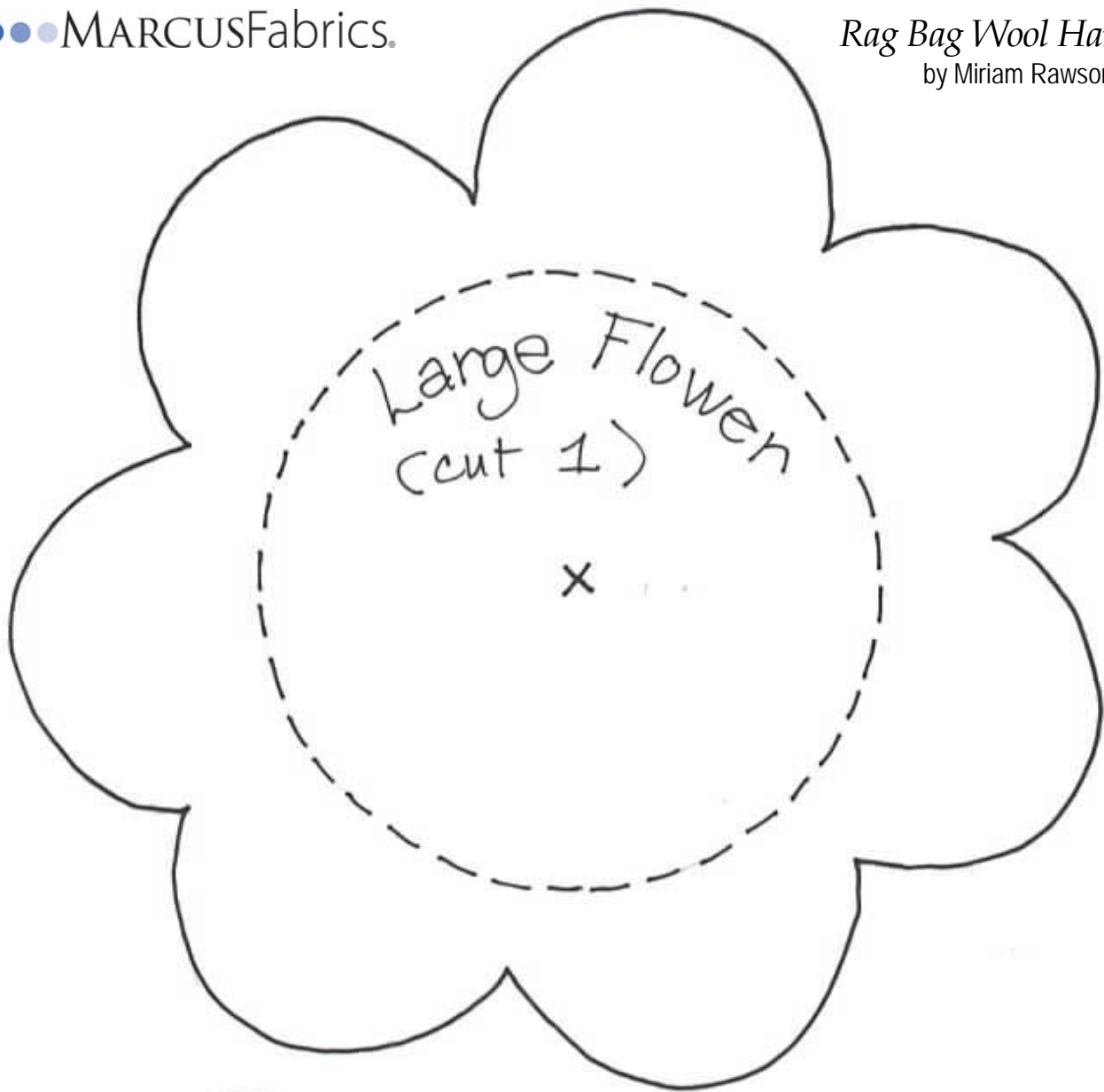

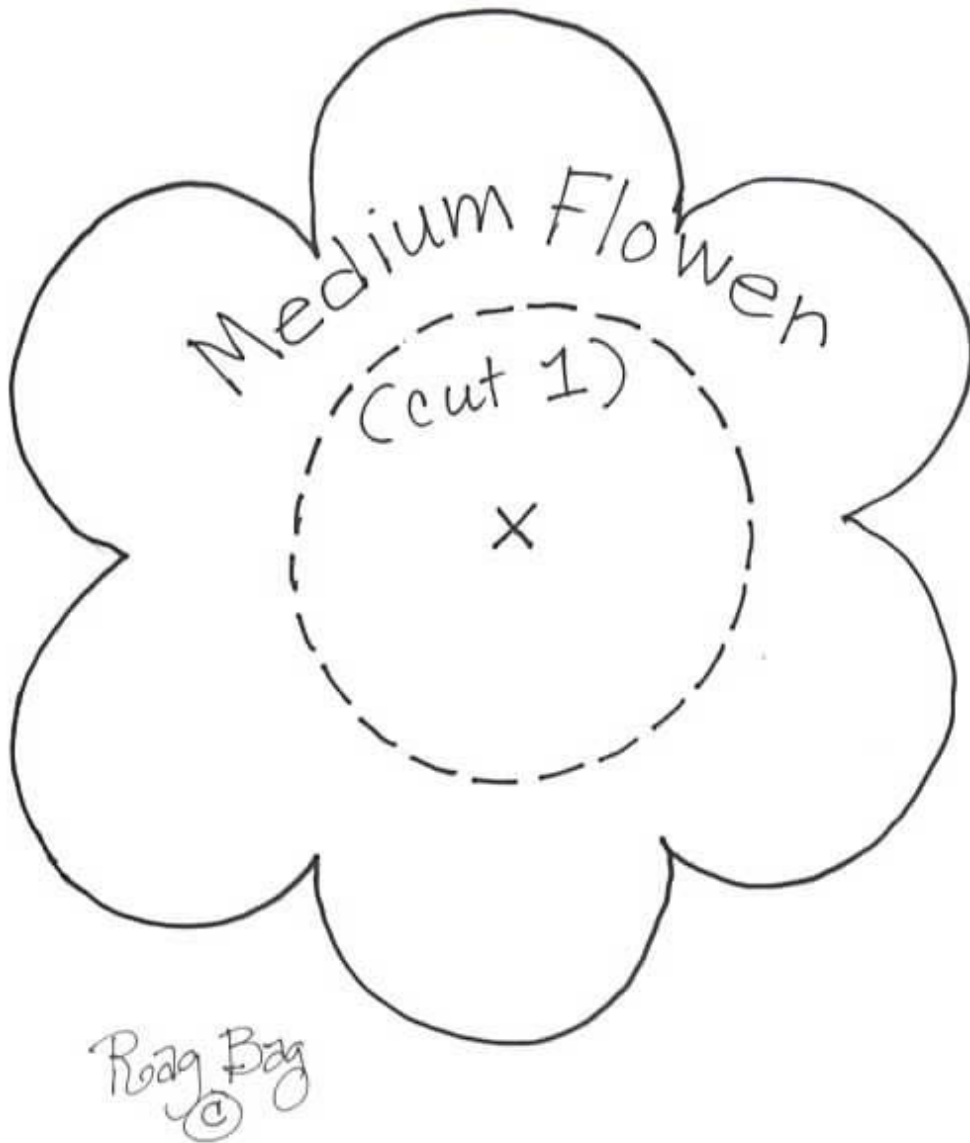

Rag Bag
©

